

Virothatch

100% recyclable synthetic thatch

SUB ROOF THATCH INSTALLATION GUIDE

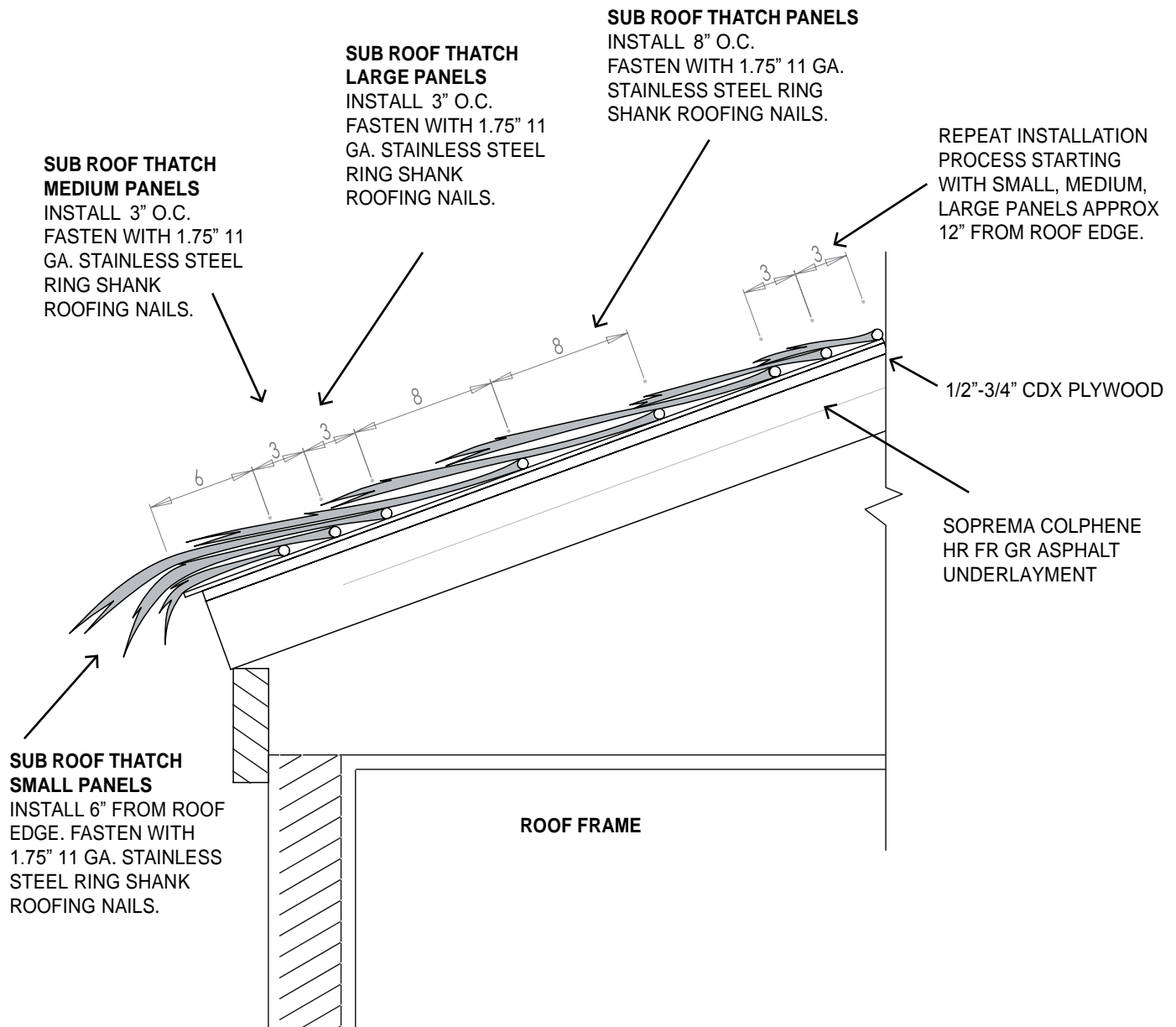

- TM-VPJ-SPS Subroof Thatch - Small Panel: 48" L, (1.219.2mm) x 17.32" H, (440mm) x .94" (24mm) Thickness
- TM-VPJ-SPM Subroof Thatch - Medium Panel: 48" L, (1.219.2mm) x 23.62" H, (600mm) x .94" (24mm) Thickness
- TM-VJP-SPL Subroof Thatch - Large Panel: 48" L, (1.219.2mm) x 27.55" H, (700mm) x .94" (24mm) Thickness
- TM-VPJ-SP Subroof Thatch Panel: 48" L, (1.219.2mm) x 35.43" H, (900mm) x .94" (24mm) Thickness
- TM-VPJ-B Subroof Thatch Bundle: 35.43" L, (900mm)

Virothatch

100% recyclable synthetic thatch

SUB ROOF THATCH INSTALLATION GUIDE

HIP INSTALLATION

THATCH BUNDLES INSTALLS ON HIP WITH 3" SDS SCREWS EVERY 24" TO THE ROOF HIP RAFTER.

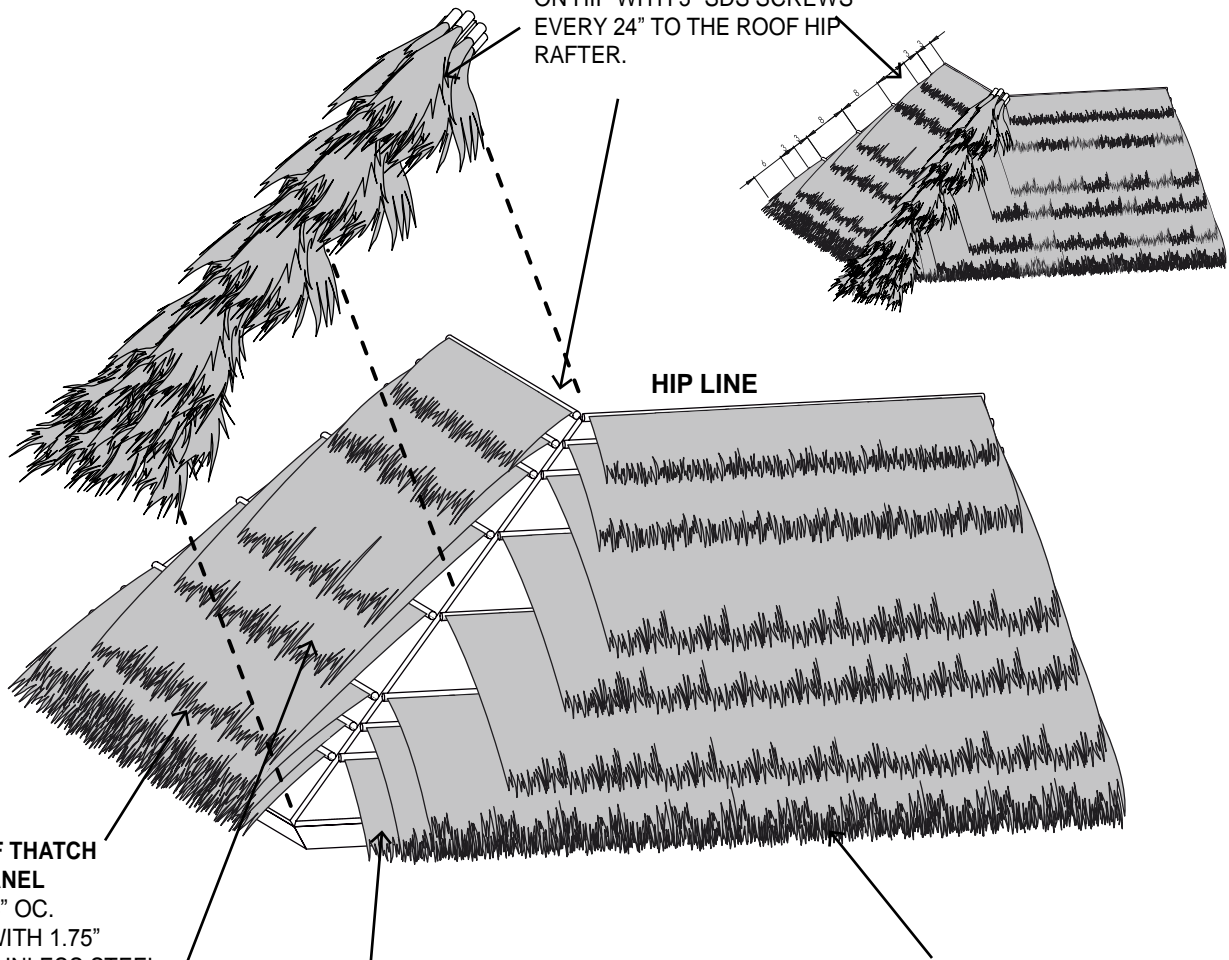

SUB ROOF THATCH LARGE PANEL
INSTALL 3" OC.
FASTEN WITH 1.75"
11 GA STAINLESS STEEL
RING SHANK ROOFING
NAILS

SUB ROOF THATCH PANEL
INSTALL 8" OC.
FASTEN WITH 1.75"
11 GA STAINLESS STEEL
RING SHANK ROOFING NAILS

SUB ROOF THATCH MEDIUM PANEL
INSTALL 3" OC.
FASTEN WITH 1.75"
11 GA STAINLESS STEEL
RING SHANK ROOFING NAILS

SUB ROOF THATCH SMALL PANELS
INSTALL 6" FROM ROOF EDGE.
FASTEN WITH 1.75"
11 GA STAINLESS STEEL
RING SHANK ROOFING NAILS

TM-VPJ-SPS Subroof Thatch - Small Panel: 48" L, (1.219.2mm) x 17.32" H, (440mm) x .94" (24mm) Thickness
TM-VPJ-SPM Subroof Thatch - Medium Panel: 48" L, (1.219.2mm) x 23.62" H, (600mm) x .94" (24mm) Thickness
TM-VJP-SPL Subroof Thatch - Large Panel: 48" L, (1.219.2mm) x 27.55" H, (700mm) x .94" (24mm) Thickness
TM-VPJ-SP Subroof Thatch Panel: 48" L, (1.219.2mm) x 35.43" H, (900mm) x .94" (24mm) Thickness
TM-VPJ-B Subroof Thatch Bundle: 35.43" L, (900mm)

THATCH BUNDLES

THATCH BUNDLES INSTALLATION
 INSTALL BUNDLES ON 2" x 2"
 x LENGTH OF HIP BEAM.

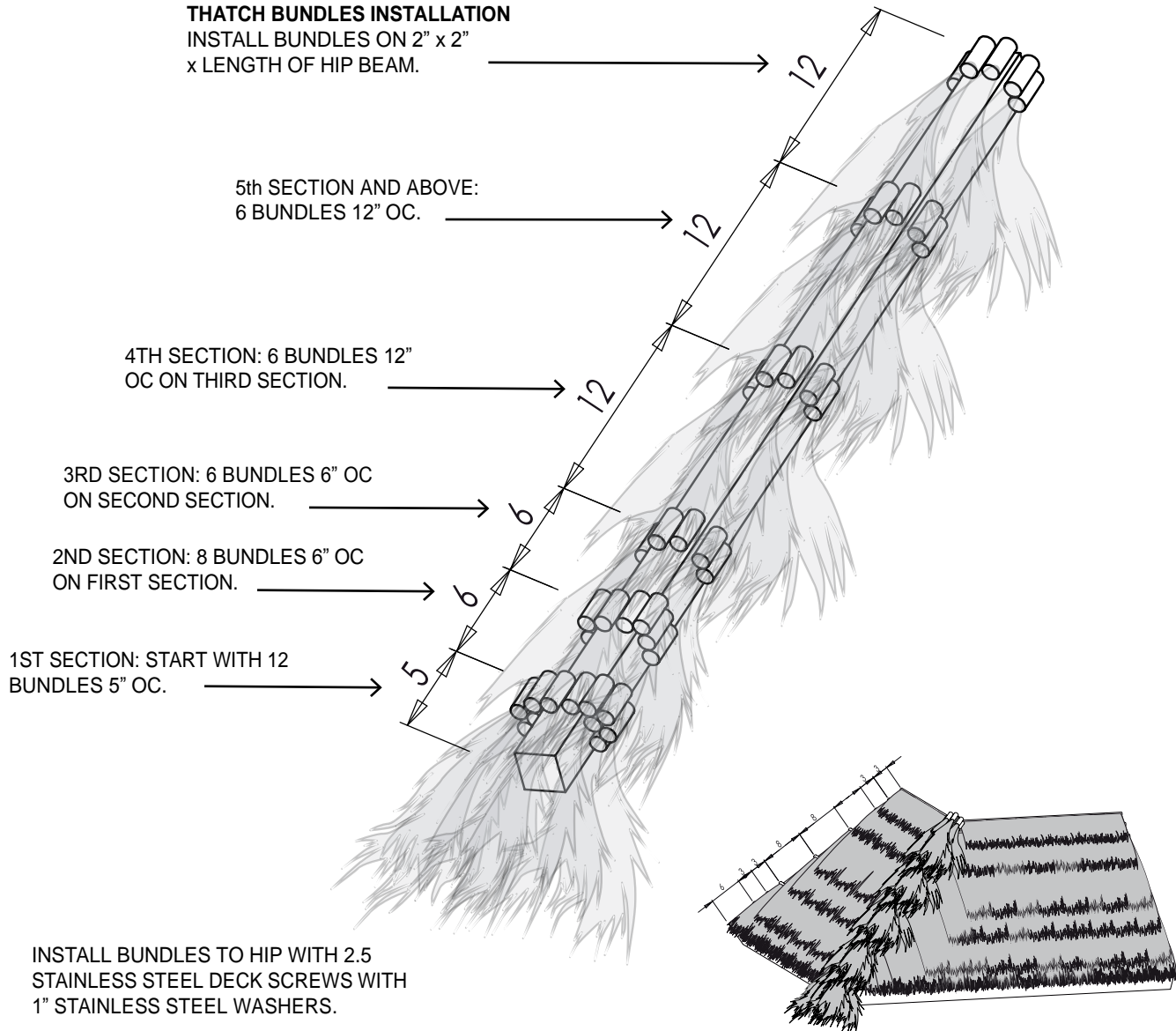

- TM-VPJ-SPS Subroof Thatch - Small Panel: 48" L, (1.219.2mm) x 17.32" H, (440mm) x .94" (24mm) Thickness
- TM-VPJ-SPM Subroof Thatch - Medium Panel: 48" L, (1.219.2mm) x 23.62" H, (600mm) x .94" (24mm) Thickness
- TM-VJP-SPL Subroof Thatch - Large Panel: 48" L, (1.219.2mm) x 27.55" H, (700mm) x .94" (24mm) Thickness
- TM-VPJ-SP Subroof Thatch Panel: 48" L, (1.219.2mm) x 35.43" H, (900mm) x .94" (24mm) Thickness
- TM-VPJ-B Subroof Thatch Bundle: 35.43" L, (900mm)

Virothatch

100% recyclable synthetic thatch

SUB ROOF THATCH VALLEY INSTALLATION

VALLEY INSTALLATION

INSTALL THE REED PANEL FLUSH TO ROOF VALLEY. DEPENDING ON THE PITCH OF THE ROOF, THE VIROTHATCH MAY NEED TO BE TRIMMED BACK SO IT DOES NOT CREATE A BUILD UP IN THE VALLEY CENTER.

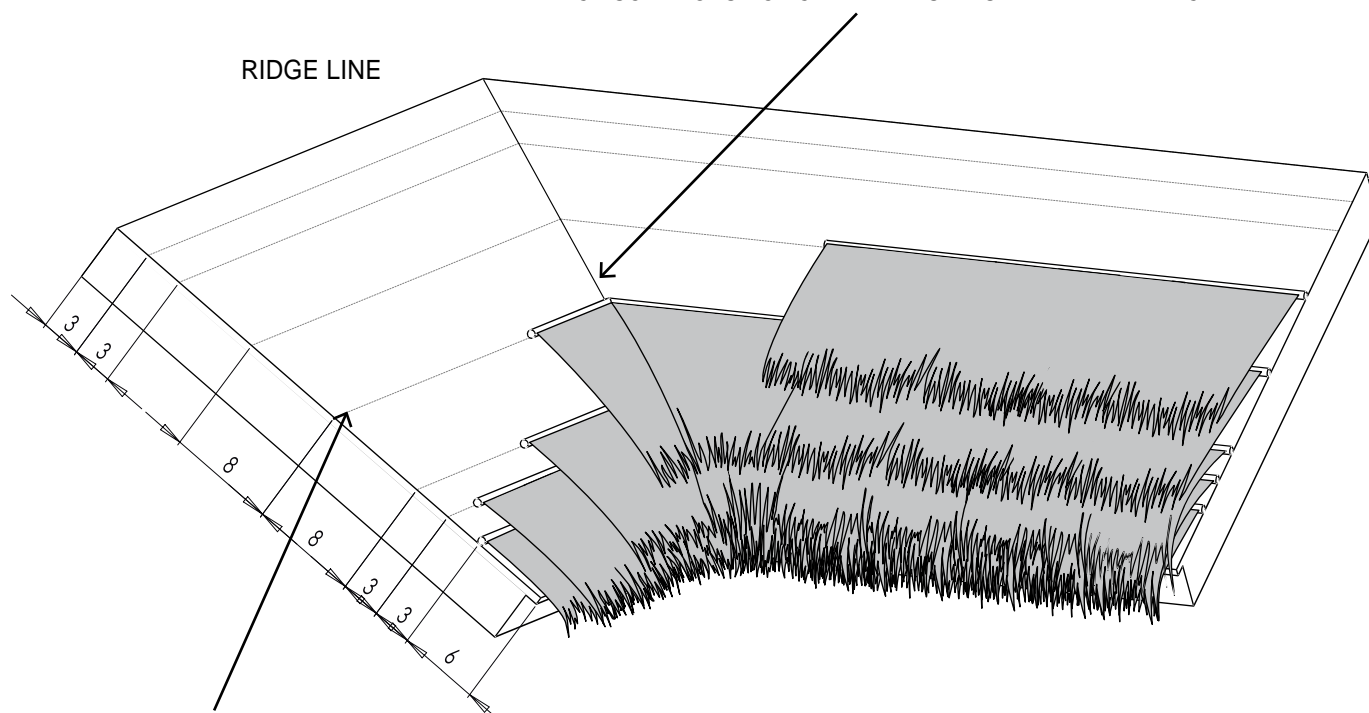

INSTALLATION SUGGESTION;
INSTALL ROOF PANELS
ABOVE AND BELOW CHALK LINE
BY 1/4" TO CREATE A MORE
NATURAL ROOF.

STAGGER THE SEAMS
ON THE FOLLOWING ROWS
WORKING UP THE ROOF
SO THEY DO NOT LINE UP.

TM-VPJ-SPS Subroof Thatch - Small Panel: 48" L, (1.219.2mm) x 17.32" H, (440mm) x .94" (24mm) Thickness
TM-VPJ-SPM Subroof Thatch - Medium Panel: 48" L, (1.219.2mm) x 23.62" H, (600mm) x .94" (24mm) Thickness
TM-VJP-SPL Subroof Thatch - Large Panel: 48" L, (1.219.2mm) x 27.55" H, (700mm) x .94" (24mm) Thickness
TM-VPJ-SP Subroof Thatch Panel: 48" L, (1.219.2mm) x 35.43" H, (900mm) x .94" (24mm) Thickness
TM-VPJ-B Subroof Thatch Bundle: 35.43" L, (900mm)



1239 Commons Ct. | Clermont, FL 34711 | 352-243-5309 | 1-877-243-5309
info@amazuluinc.com | www.amazuluinc.com